



## LEVELe® WALL CLADDING SYSTEM

PRODUCT DATA





## LEVELe® WALL CLADDING SYSTEM

PRODUCT DATA

The LEVELe Wall Cladding System was designed to accommodate a wide range of field conditions, without sacrificing ease of specification, installation or maintenance. Four distinct panel styles - Minimal, Float, Capture and Blind - allow our full palette of materials, as well as many third party materials, to be used. Aluminum-framed panels with structural backing form the basis for the system, which is finished with clean interior and exterior corners, bases, and self-revealing extruded aluminum mounting channels. Ensuring design continuity throughout a space, the LEVELe Wall Cladding System coordinates with our LEVELe Elevator Interiors and LEVELe Column System. Continue the look with doors, frames and elevator door skins, all of which can be specified with the same palette of high-performance materials.

**WALL COMPATIBILITY** - The LEVELe Wall Cladding System can be specified for many field conditions. LEVELe wall panels and corner components have sufficient tolerances built into them to accommodate the majority of out-of-square conditions or other dimensional irregularities.

**STANDARD COMPONENTS** - Wall Panels, Panel Subsystem, Base, Corners, Reveals, and Installation Hardware

### PANEL & COMPONENT DETAILS

WALL PANELS			
<ul style="list-style-type: none"><li>The LEVELe Wall Cladding System is assembled using a series of individual wall panels whose sizes and shapes vary depending on the specification and field conditions. Each individual wall panel comprises two distinct, configurable elements: panel frames and insets. Four panel types are available: Minimal, Capture, Float and Blind (see pages four through seven for details).</li><li>Panel frames serve as the framing elements for the insets and also incorporate LEVELe's innovative wall panel attachment system. Panel frames are extruded aluminum and are available in a choice of Clear, Black, or Antique Bronze anodized finishes in Minimal and Capture panel frames; Float and Blind panel frames are available in Black anodized finish only. All panel frame corners are mitered.</li><li>Insets consist of a decorative face material bonded to a structural substrate. Inset materials available vary by panel type. Total wall panel thickness including frame ranges from 0.71" to 1.02" (18 to 26 mm), depending on panel style. Please see pages four through seven for details.</li></ul>			
PANEL SUBSYSTEM		BASE	CORNERS
<b>VERTICAL ELEMENTS</b> <ul style="list-style-type: none"><li>Hat channel extrusion</li><li>Outside corner extrusion</li><li>End stop extrusion</li><li>Hat channel covers (reveals)</li></ul>	<b>HORIZONTAL ELEMENTS</b> <ul style="list-style-type: none"><li>Base cleat extrusion</li><li>Wall reveal cleat extrusion</li><li>Top cleat extrusion</li></ul>	<ul style="list-style-type: none"><li>A 4" (101.6 mm) high base is fitted between the finished floor and wall panels.</li><li>Base consists of black face cover applied to an extruded aluminum substrate with pre-mounted adhesive.</li></ul>	<p><b>Outside Corner details</b> vary to complement the four panel conditions:</p> <ul style="list-style-type: none"><li>Minimal &amp; Capture Panels: extruded Aluminum corner detail, available in Clear, Black or Antique Bronze anodized Aluminum to match framing details.</li><li>Blind &amp; Float Panels: a corner extrusion that accommodates facing material to complement the panel inset material.</li></ul> <p><b>Inside Corner details:</b></p> <ul style="list-style-type: none"><li>90° angled corner extrusions are supplied for interior corners. Reveals are Black anodized Aluminum.</li></ul>

### PANEL FRAME AND CORNER COLOR OPTIONS

Panel frames are extruded aluminum and are available in a choice of Clear, Black or Antique Bronze anodized finishes. Reveals are extruded aluminum and are standard in black, additional colors are available for an additional fee.



Clear



Black



Antique Bronze



## LEVELe® WALL CLADDING SYSTEM

PRODUCT DATA

### STANDARD INSET MATERIAL OPTIONS

STAINLESS STEEL	BONDED METAL® & BONDED QUARTZ	VIVIDGLASS
Stainless steel can be specified for insets in all of our standard finishes. In addition, a variety of three-dimensional patterns can be applied to insets to add visual interest or to enhance functionality. Please refer to our website and the Stainless Steel Product Data Sheet for complete information on available stainless steel finishes and patterns.	<p>Light in weight yet extremely durable, Bonded Metal's high relief, highly detailed surface has the character and appearance of solid metal. Please refer to the Bonded Metal Product Data Sheet for finish swatches and additional information.</p> <p>Unlike anything else on the market, Bonded Quartz combines ceramic microspheres and a fiber-reinforced polymer matrix to create a material that is lightweight, durable, and easy to clean. The standard color for Bonded Quartz is Bonded White; custom colors are also available for larger projects. Please refer to the Bonded Quartz Product Data Sheet for finish swatches and additional information.</p>	Many of our VividGlass design options can be specified including selections from our ViviChrome, ViviGraphix, ViviSpectra, ViviStone and ViviStrata families. Please refer to the VividGlass Product Data Sheets for pattern swatches and additional information.
FUSED METAL®	WOOD VENEER	BERMANGLOSS LEVELS KILN CAST GLASS
Fused Metal is Forms+Surfaces' exclusive line of colored stainless steel created by fusing titanium alloys to the stainless substrate at the molecular level. Fused Metal provides the durability and low maintenance of stainless steel in a range of rich color options and can be specified for insets and ceilings. Please refer to the Fused Metal Product Data Sheet for finish swatches and additional information.	Our natural wood veneers are finished with three coats of polyurethane for superior abrasion resistance while maintaining all the richness and authenticity of genuine wood. Please refer to the Wood Veneer Product Data Sheet for material options and additional information.	<p>BermanGlass Levels glass is artisanal kiln cast glass laminated with color and graphic interlayers to bring creative plays of texture, color and light to walls, columns, elevator interiors and more.</p> <p>Please refer to the BermanGlass Levels Kiln Cast Glass Product Data Sheet for design swatches and additional information.</p>

### THIRD PARTY INSET MATERIALS

Customers sometimes wish to specify their own inset materials to match lobby walls or other areas on specific projects. This is generally feasible, provided the materials meet certain dimensional requirements. Please call for more information.

### RELATED PRODUCTS

LIGHTPLANE PANELS	ARCHITECTURAL ACCENTS	LEVELe ELEVATOR INTERIORS
LightPlane panels are engineered LED edge-lit panels that are a standard offering in our LEVELe Wall Cladding System - allowing you to seamlessly illuminate a wall. LightPlane panels have the same visible profile as Capture panels and are available exclusively with a wide range of our VividGlass and BermanGlass Levels Kiln Cast Glass products. Please refer to the LightPlane Product Data Sheet for pattern options and additional information.	Sheet goods to match your elevator interior are available for headers, jams, returns, transoms and other areas. Our litter & recycling receptacles, site furnishings and other amenities are all available in materials and finishes that complement those offered in the LEVELe Wall Cladding System.	Our LEVELe Elevator Interiors can be incorporated in matching colors, patterns and finishes in areas surrounding elevators. LEVELe Elevator Interiors are available in the same materials and finishes that are offered in LEVELe Wall Cladding System.
LEVELe COLUMN SYSTEM	DOORS	ELEVATOR DOOR SKINS
LEVELe Column System allows for a range of materials to be incorporated into any design project. Forms+Surfaces' LEVELe Column System draws on our extensive palette of options and may be specified in a wide range of materials and finishes. Please see the LEVELe Column System Product Data Sheet for additional information.	Forms+Surfaces also manufactures a complete range of entrance doors and door pulls in matching materials and finishes to LEVELe Wall Cladding System.	Forms+Surfaces Elevator Door Skins can be incorporated in matching colors, patterns and finishes.



## LEVELe® WALL CLADDING SYSTEM

PRODUCT DATA

### DELIVERY & INSTALLATION

DELIVERY	WALL PANEL INSTALLATION	PANEL REPLACEMENT
Wall panels, bases and reveals for each individual wall arrive in a single crate, making it easy to organize materials on site. The crate arrives with components neatly organized and includes all the necessary fasteners, adhesives and installation instructions.	Designed to be straightforward and efficient, the LEVELe installation accommodates many field conditions with the following summarized sequence: <ul style="list-style-type: none"><li>• First, the vertical hat channel extrusions are attached with self-tapping screws, shimmed as required to establish a planar basis for the wall cladding system.</li><li>• The corner extrusions are set next and leveled to the plane just created.</li><li>• The horizontal base cleat and reveal, followed by the wall reveal cleats, and finishing with the top cleat are installed next, working up the wall.</li><li>• Vertical reveals are then attached in the corners and affixed to the hat channels.</li><li>• Lastly, the panels are engaged via a French cleat system. Note: panels can be installed and replaced independently and in any order.</li></ul>	If wall panels are ever damaged due to accident or vandalism, replacement panels can be ordered from Forms+Surfaces. The attachment system permits one panel to be removed without disturbing those around it, keeping downtime to a minimum.

### MAINTENANCE

STAINLESS STEEL & FUSED METAL	BONDED METAL & BONDED QUARTZ	VIVIDGLASS & BERMANGLOSS LEVELS KILN CAST GLASS	WOOD VENEER
Fingerprints and smudges can be removed using a non-chlorinated spray cleaner/degreaser such as Simple Green® and a microfiber cloth. Do not use harsh abrasives, acids or chlorine-based cleaners or cleaning tools containing carbon steel, such as steel wool or wire brushes.	Bonded Metal & Bonded Quartz require very little maintenance. Routine dust should be removed by periodic vacuuming or with a soft brush. Fingerprints, smudges and more persistent dirt can be removed by using an ammonia-free cleaner/degreaser such as Simple Green.	VividGlass and BermanGlass surfaces can be maintained using standard commercial, non-streaking cleaners and polishes formulated for use on glass.	Veneer surfaces can be maintained using standard commercial cleaners and polishes formulated for use on interior woods.

### TECHNICAL SUPPORT & PROJECT MANAGEMENT

Because each project is unique, our knowledgeable support team is ready to help. Our technical sales, engineering, sustainability, and project management professionals regularly assist our clients worldwide.

### CUSTOM WALLS

If your design requirements go beyond the standard LEVELe configurations, material and finish offerings, customized versions are available for an additional charge. Please call us to discuss your needs.

### HOW TO SPECIFY

Design Guides are available for each of the panel configurations to lead you through the specification process in a simple, checkbox format. The Design Guide captures all the information needed to generate a quote: dimensions, finishes, and other options. CSI specifications are also available on our website.



## LEVELe® WALL CLADDING SYSTEM

PRODUCT DATA

### MINIMAL PANEL

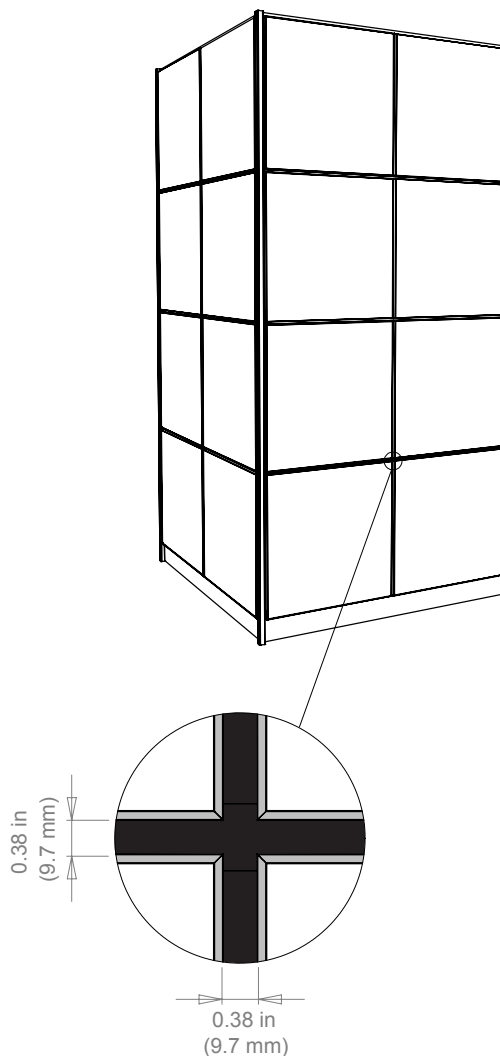
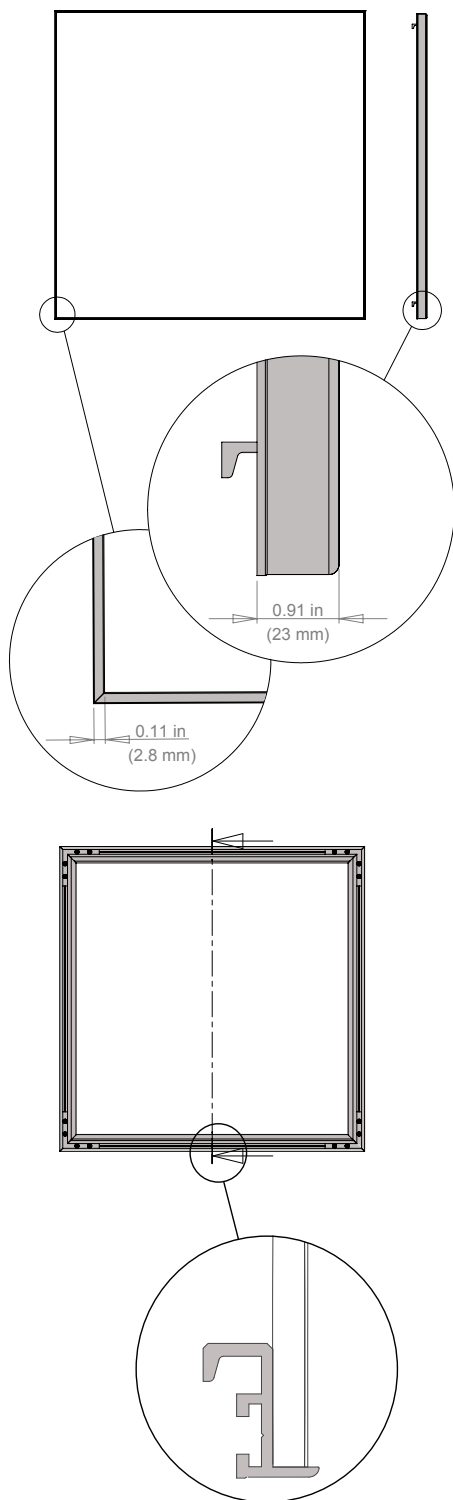

The Minimal profile matches that of the LEVELe Elevator Interiors for those who want a uniform look from elevator to lobby.

Minimal panel insets can be specified with the following Forms+Surfaces materials:

- Stainless Steel
- Bonded Metal\*
- Wood Veneer
- Fused Metal
- Bonded Quartz\*
- VividGlass

\*Some patterns not available in Minimal panels.

Please call us to discuss third party materials.



## LEVELe® WALL CLADDING SYSTEM

PRODUCT DATA

### CAPTURE PANEL

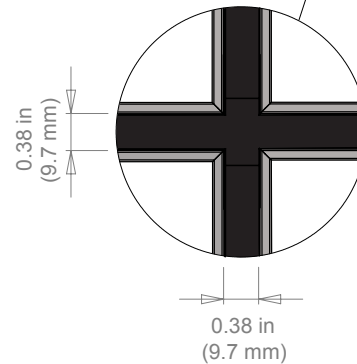
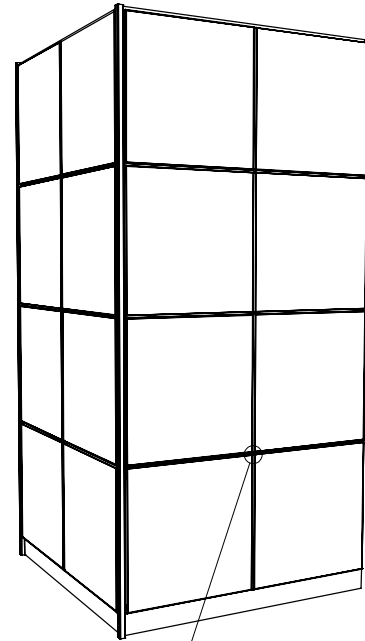
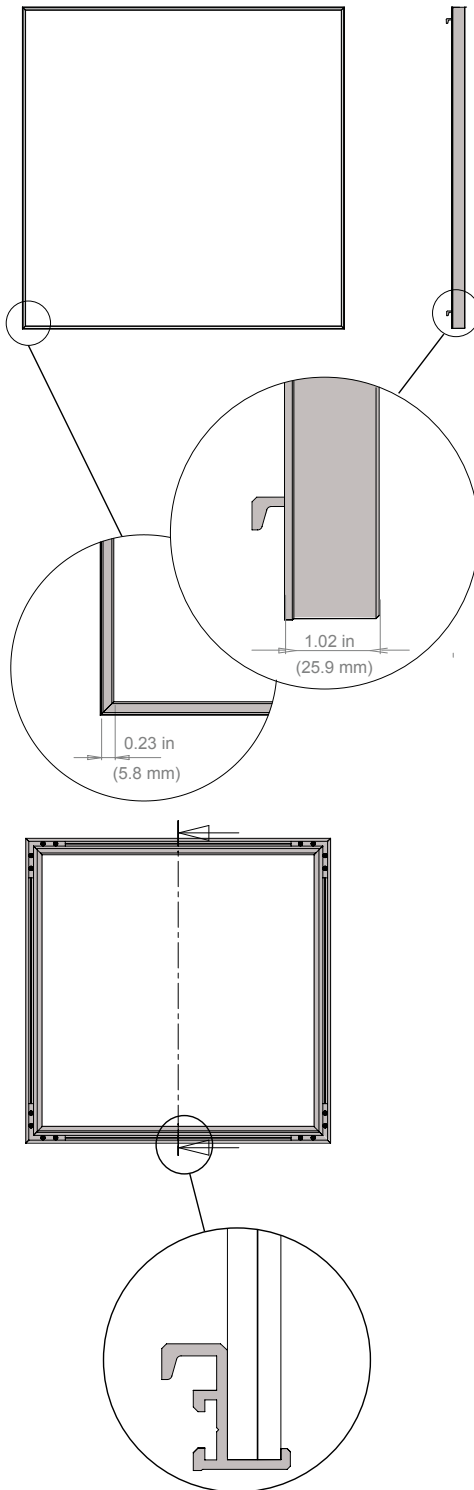

The Capture panel was designed to accommodate thicker, heavier materials, such as glass, that require a frame with a capture edge. Matching Capture panels are available in our LEVELe Elevator Interiors for those who want a uniform look from elevator to lobby.

Capture panels can be specified with the following Forms+Surfaces materials:

- Stainless Steel
- Bonded Metal
- VividGlass
- Wood Veneer
- Fused Metal
- Bonded Quartz
- BermanGlass Levels

Please call us to discuss third party materials.



## LEVELe® WALL CLADDING SYSTEM

PRODUCT DATA

### BLIND PANEL

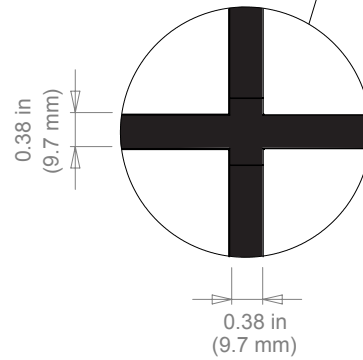
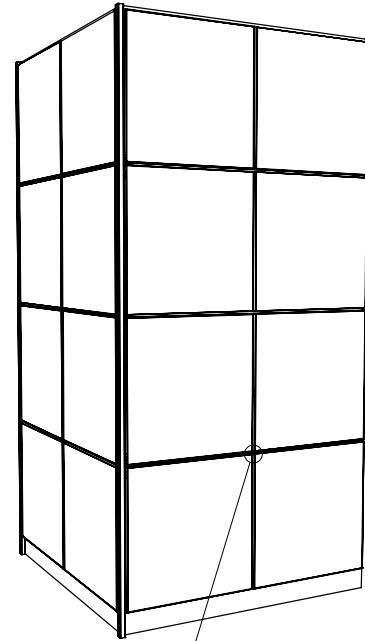
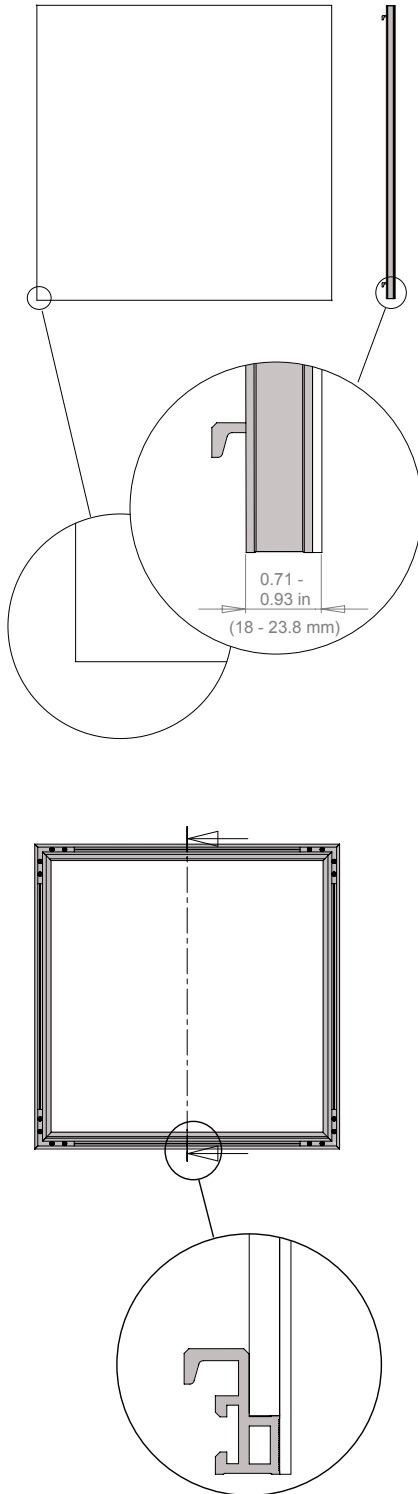

Blind panels are designed so that the frame is not visible from front of panel, helping to create the illusion of material thickness. When using laminated glass, the frame can also be recessed so that it is not visible at the edge of the panel.

Blind panels can be specified with the following Forms+Surfaces materials:

- Stainless Steel
- Fused Metal
- VividGlass with polished edge

Please call us to discuss third party materials.



## LEVELe® WALL CLADDING SYSTEM

PRODUCT DATA

### FLOAT PANEL

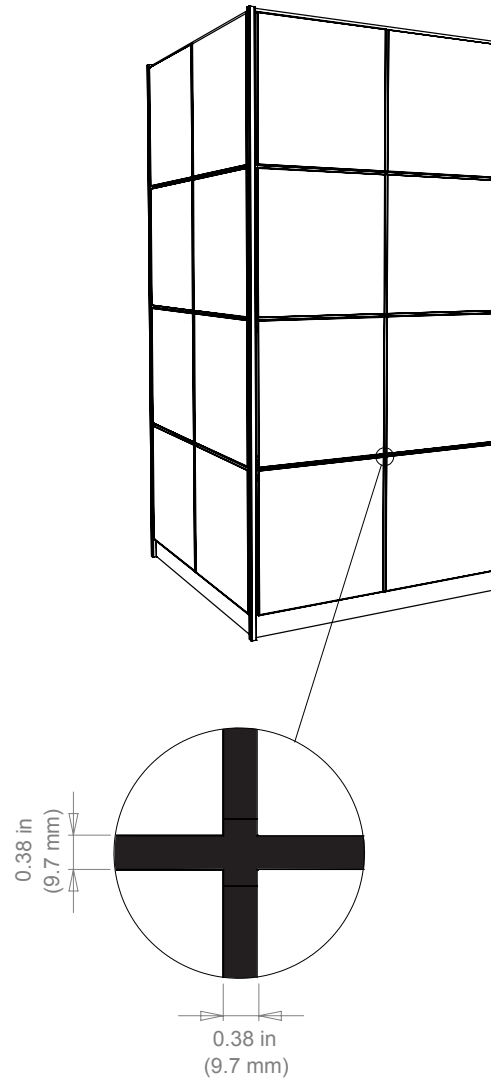
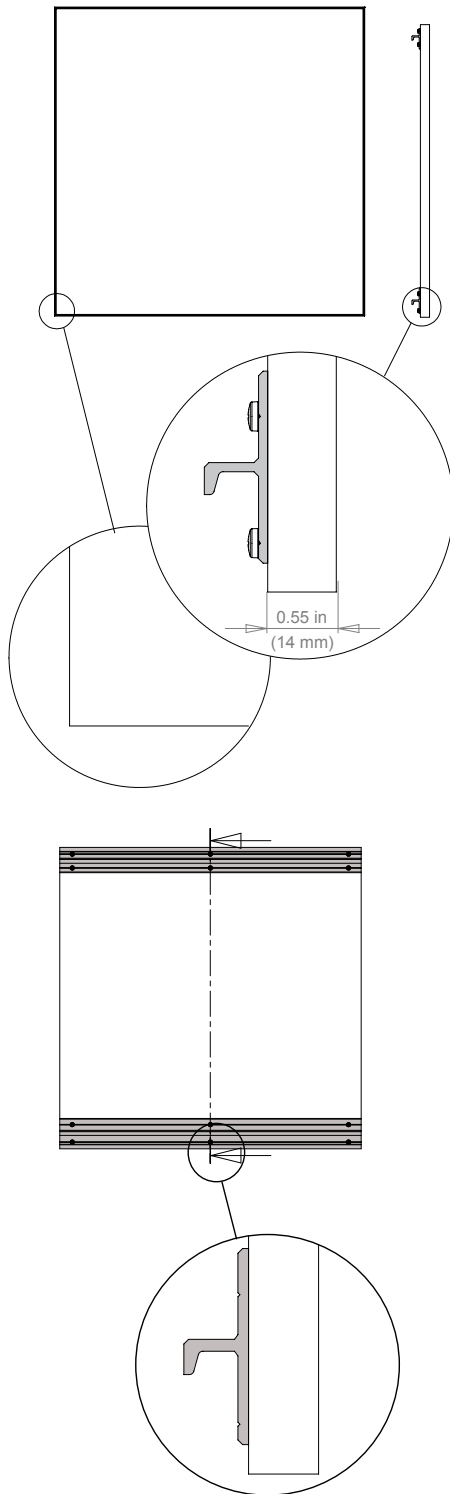

Float panels are designed for material that typically can be brakeformed or edge banded around a backer.

Float panels can be specified with the following Forms+Surfaces materials:

- Stainless Steel
- Fused Metal
- Wood Veneer

Please call us to discuss third party materials.





## LEVELe® WALL CLADDING SYSTEM

PRODUCT DATA

### STANDARD COMPONENTS

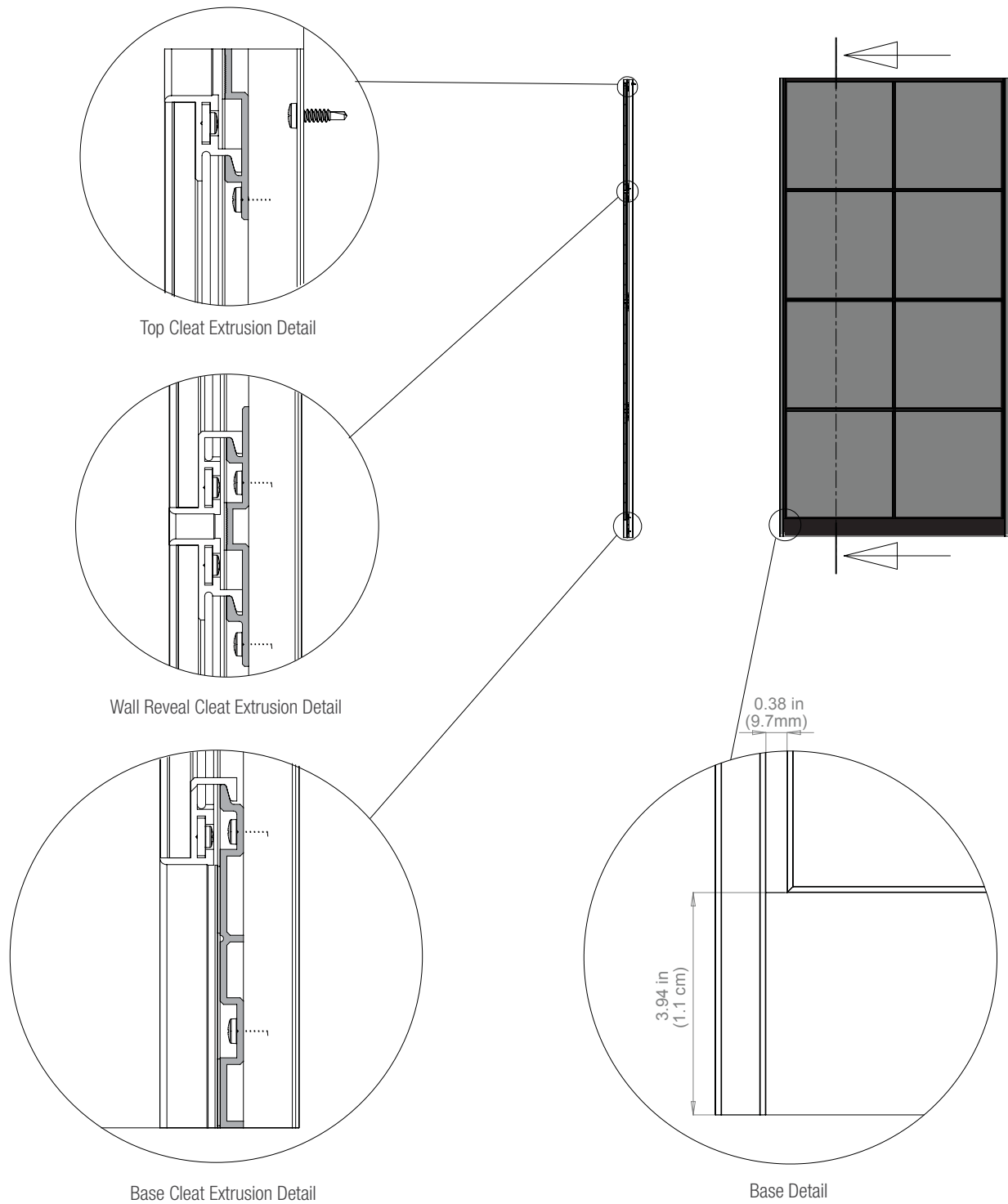

T 1.800.451.0410 | F 412.781.7840 | [www.forms-surfaces.com](http://www.forms-surfaces.com)

**FORMS+SURFACES®**

© 2017 Forms+Surfaces® | All dimensions are nominal. Specifications and pricing subject to change without notice. For the most current version of this document, please refer to our website at [www.forms-surfaces.com](http://www.forms-surfaces.com).



## LEVELe® WALL CLADDING SYSTEM

PRODUCT DATA

### STANDARD COMPONENTS

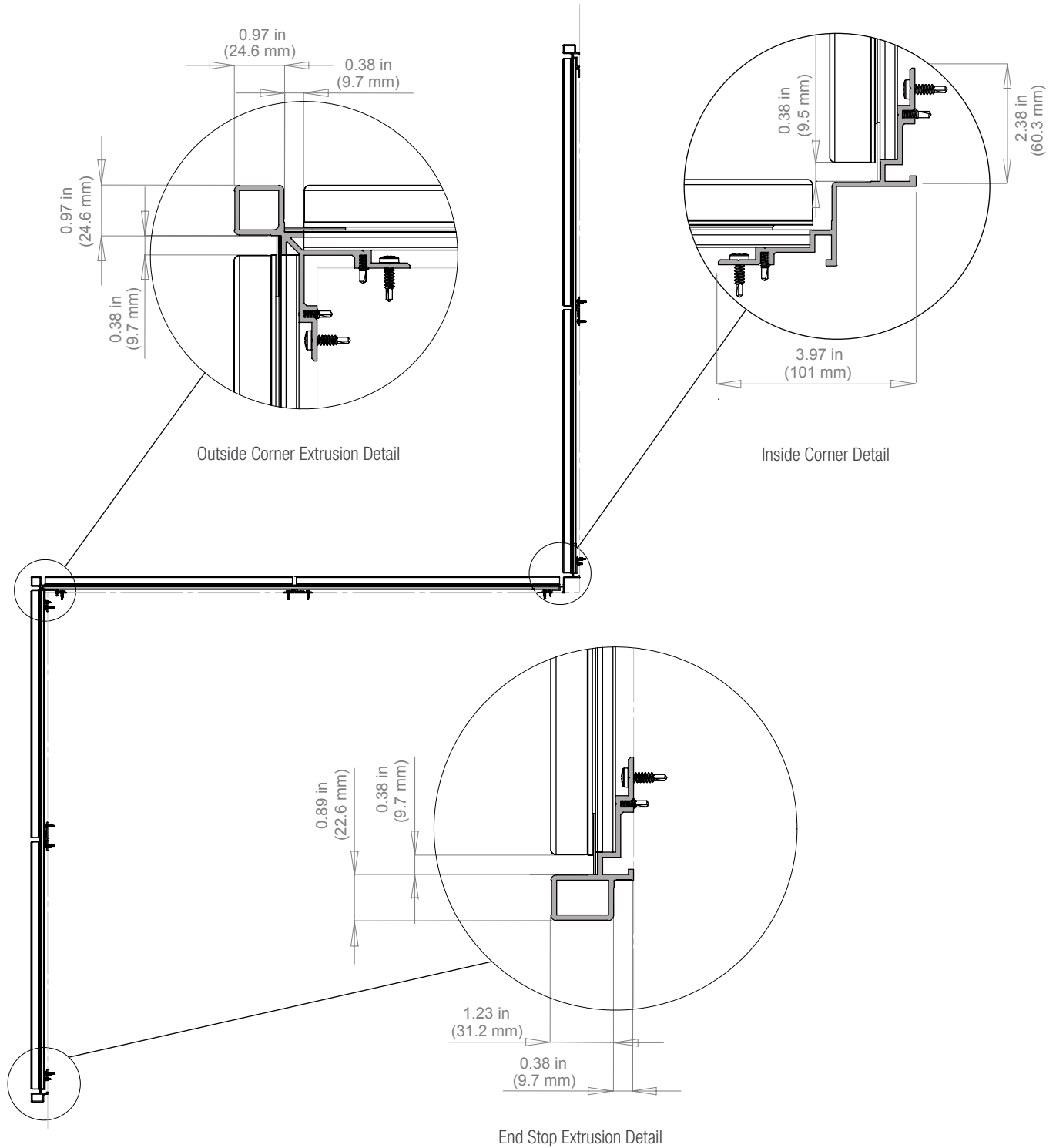

T 1.800.451.0410 | F 412.781.7840 | [www.forms-surfaces.com](http://www.forms-surfaces.com)

**FORMS+SURFACES®**

© 2017 Forms+Surfaces® | All dimensions are nominal. Specifications and pricing subject to change without notice. For the most current version of this document, please refer to our website at [www.forms-surfaces.com](http://www.forms-surfaces.com).